

REMOTE DESIGN AND QUOTE SERVICE GUIDE FOR



**We'll get your 2020 designs and quotes to you in just
two days.**

HOW IT WORKS

INITIAL DESIGN

- 1 Get the kitchen measurements ready. Then sketch where the appliances and cabinets go. Here's a good example of what works best:

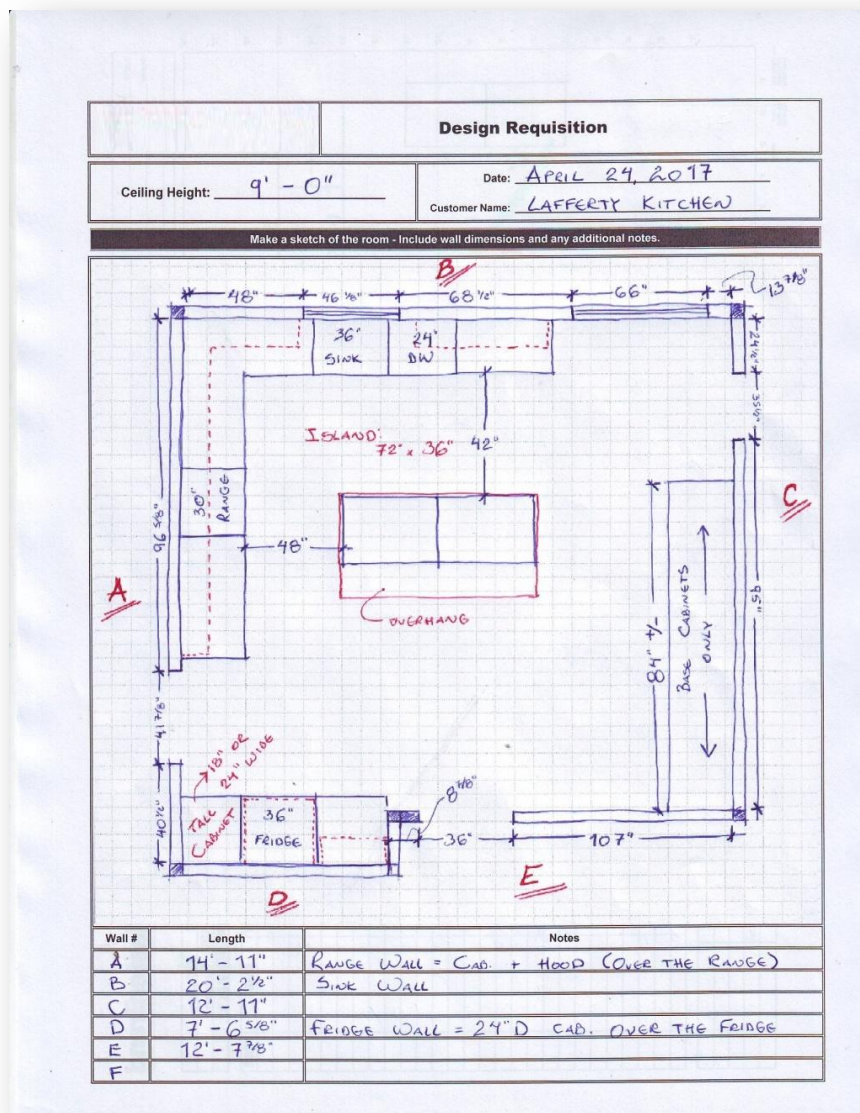

2 Get the bathroom, mudroom, etc. measurements ready. We'd like cabinet sizing and codes for these areas. Here's a good example of what your designer can work with:

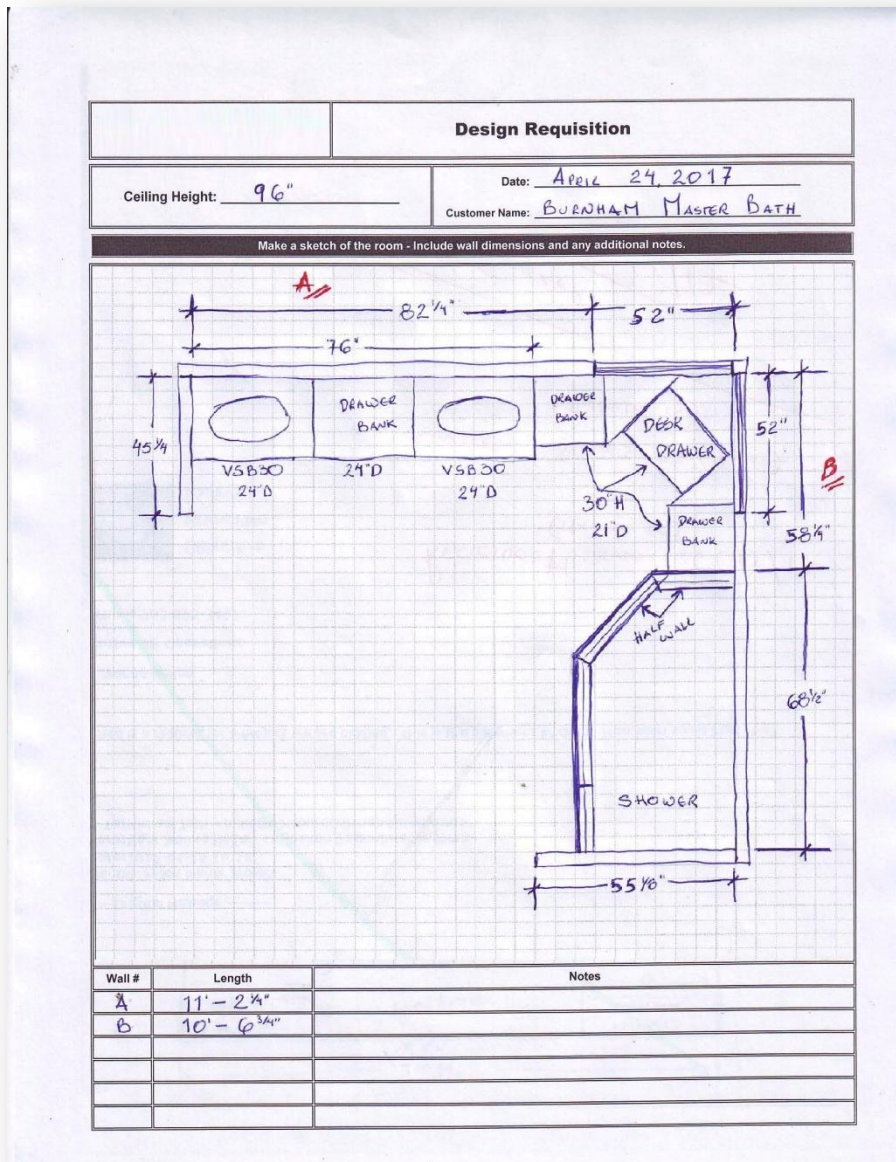

- 3** Either take a smart phone photo or scan the measurements.

- 4** Now begin your online design submittal by clicking:
designs@masterkd.com.

- 5** Click which cabinet brand to design.

- 6** Complete the online submittal for all the rooms to design.

- 7** Upload the measurements and cabinet sketches and click SUBMIT

- 8** You'll receive a confirmation with both the design completion date and a design registration number.

- 9** In two days you'll receive a full design and quote package. The 2020 file is also included for those who'd like to continue designing on their own. Here's what's included in the design package: (color drawings, floor plan, wall views with measurements and quote)

2 Option #2 - If the changes are simple, then just list them on the online submittal.

3 Begin your design changes by clicking: designs@masterkd.com.

4 Click: **DESIGN CHANGE ONLY** and enter the design number from the original design.

5 Upload any plans with design change notes and/or outline the changes on the submittal. Click the **SUBMIT** button.

6 You'll receive a confirmation with the design completion date.

7 In two days you'll receive a full design and quote package. The 2020 file is also included for those who'd like to continue designing on their own. Here's what's included in the design package: (color drawings, floor plan, wall views with measurements and quote)

DARIS, ASHFIELD KITCHEN

Supplier	Material/Color/Finish	Drawer Front	White Int. - Hardwood Overlay - Full Ext w- 90° Close
1	1 71000004	Full Over 30" x 18 1/2" Flat	2,283.00
11	1 82	Hardwood 30" x 24" Tray (2 1/4")	422.00
2	1 71000002	Full Over 30" x 24"	2,285.00
11	1 71000000	Finished End Left	215.00
3	1 71000000	Full Over 30" x 24"	2,291.00
4	1 910000	Full Over 30"	194.00
11	1 910000	Working Veneer Interior (2-PLY)	475.40
42	2 910000	Medium-Wipe	362.00
8	1 910000	Full Over 30"	140.00
4	1 910000	Full Over 30"	141.00
11	1 910000	Working Veneer Interior (2-PLY)	304.60
42	2 910000	Medium-Wipe	362.00
7	1 910000	Full Over 30"	189.00
1	1 920000	Over Crown 30" x 48"	1,176.00
11	1 910000	Finished End Both	278.00
82	2 910000	White Cabinet Tray 10" W	470.00
8	1 910000	Over Crown 30" x 36"	1,120.00
11	1 910000	Finished End Both	278.00
10	1 910000	Full Over 30" x 24" x 18" w/ 90°	165.00
11	1 910000	Over Crown 30" x 24"	45.00
12	2 910000	Medium-Wipe	160.00
13	4 910000	Medium-Wipe Over Crown 30" x 24" w/ 90°	390.00
14	4 910000	Bus Mounting 30"	340.00
15	2 910000	Traditional Wood Edge Light Rail 30"	170.00
Cabinets subtotal			
17,129.00			
Charges			
11	1 11	Delivery (2-PL)	1,081.88
11	1 11	Permitting 100'	1,017.86
11	1 11	Soft Close Logistics	400.00
11	1 11	White Int. - Hardwood Overlay - Full Ext w- 90° Close	0.00
Cabinets w/ install			
19,628.74			
Accessories			
11	1 11	1 11	1 11
11	1 11	1 11	1 11
Charges			
27.80			
QUOTE SUMMARY			
KICKAMBA, 1 Per sqft	87.82		28,293.32
KICKAMBA, 1 Per sqft	87.82		28,293.32
Quote total			56,586.64
Volumes	323.12	Weight	128.85

Contact us with any questions to:
designs@masterkd.com